

Material:

Housing: 30% Glass filled PA46 UL94V-0.

Contacts: Phosphor Bronze.

Electrical Characteristics:

Current Rating: 1 AMP.

Dielectric Withstanding Voltage: AC 1000V For 1 minute.

Insulator Resistance: 1000MΩmin. at DC 500V.

Contact Resistance: 30mΩmax. at DC 100mA.

Operating Temperature: -55°C ~ +105°C.

Features:

- * 1.27mm Pitch.
- * 60P Male, Vertical.

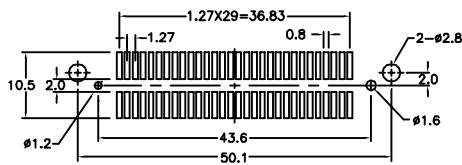
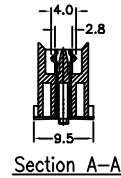
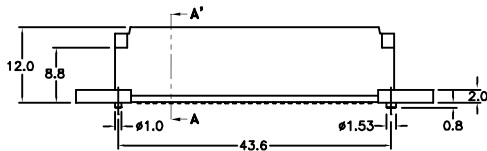
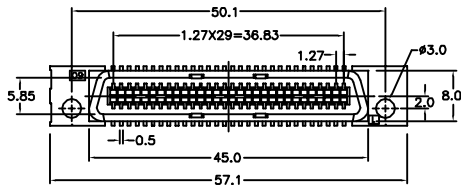

P.C. Board Layout

Ordering information

SC01-	60	M	3	3	10
Series	Position	Male	3: Surface Mount	3: Selective Gold Plated	10: 10 μ" 15: 15 μ" 30: 30 μ"