

REV.	SPECIFICATION	ECN NO.	APPD.
R1			

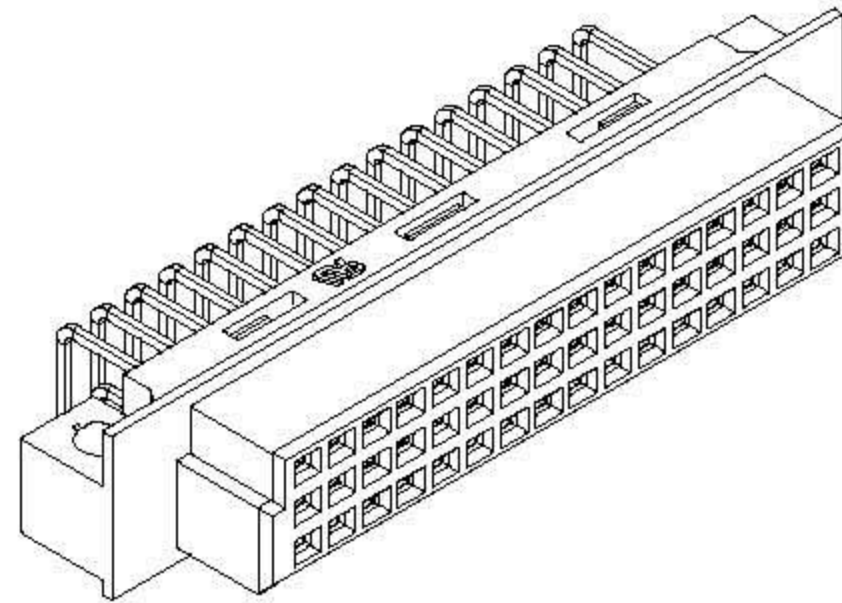
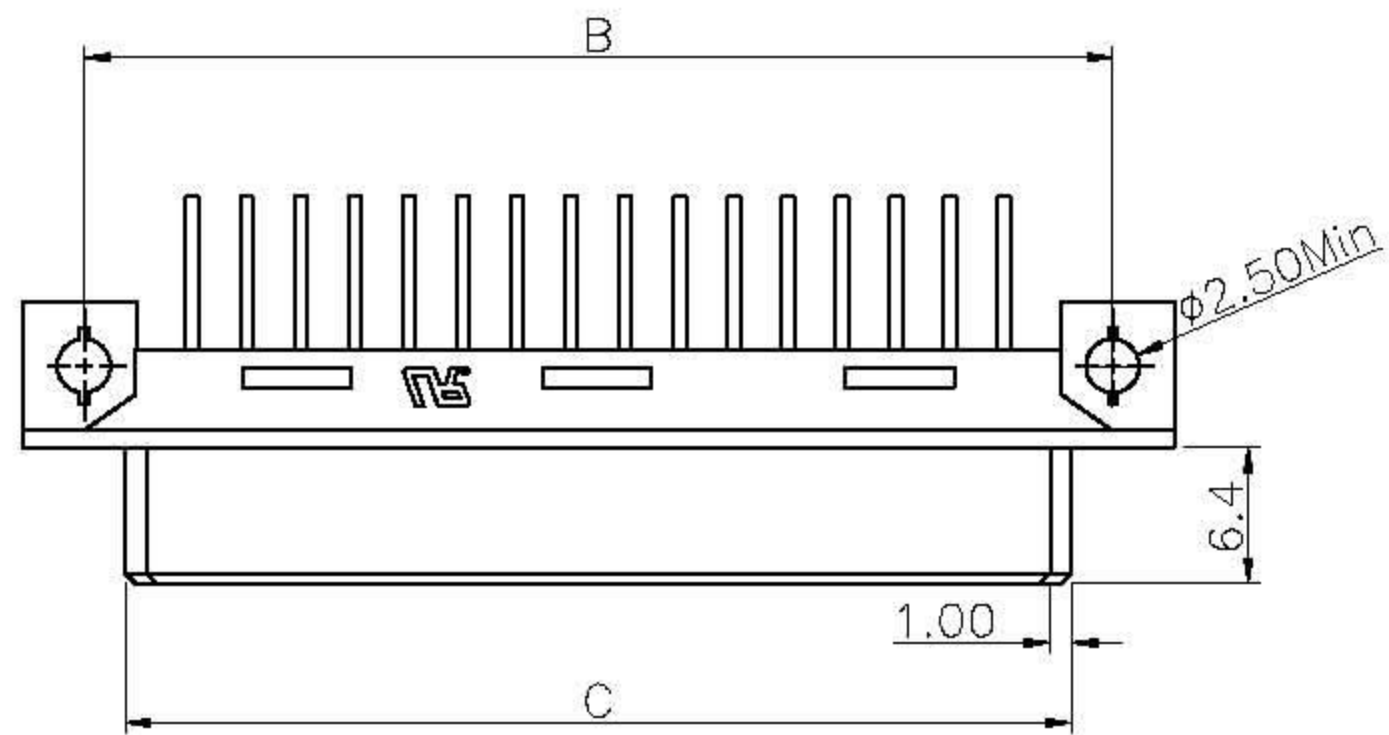

Material:

Housing: Thermoplastic Polyester Glass Filled UL94V-0.

Contacts: Copper Alloy.

Electrical Characteristics:

Current Rating: 2 AMP.

Dielectric Withstanding Voltage: AC 1000V For 1 minute.

Insulator Resistance: 1000M Ω min. at DC 500V.

Contact Resistance: 20m Ω max. at DC 100mA.

Operating Temperature: -55°C ~ +125°C .

***RoHS Compliant**

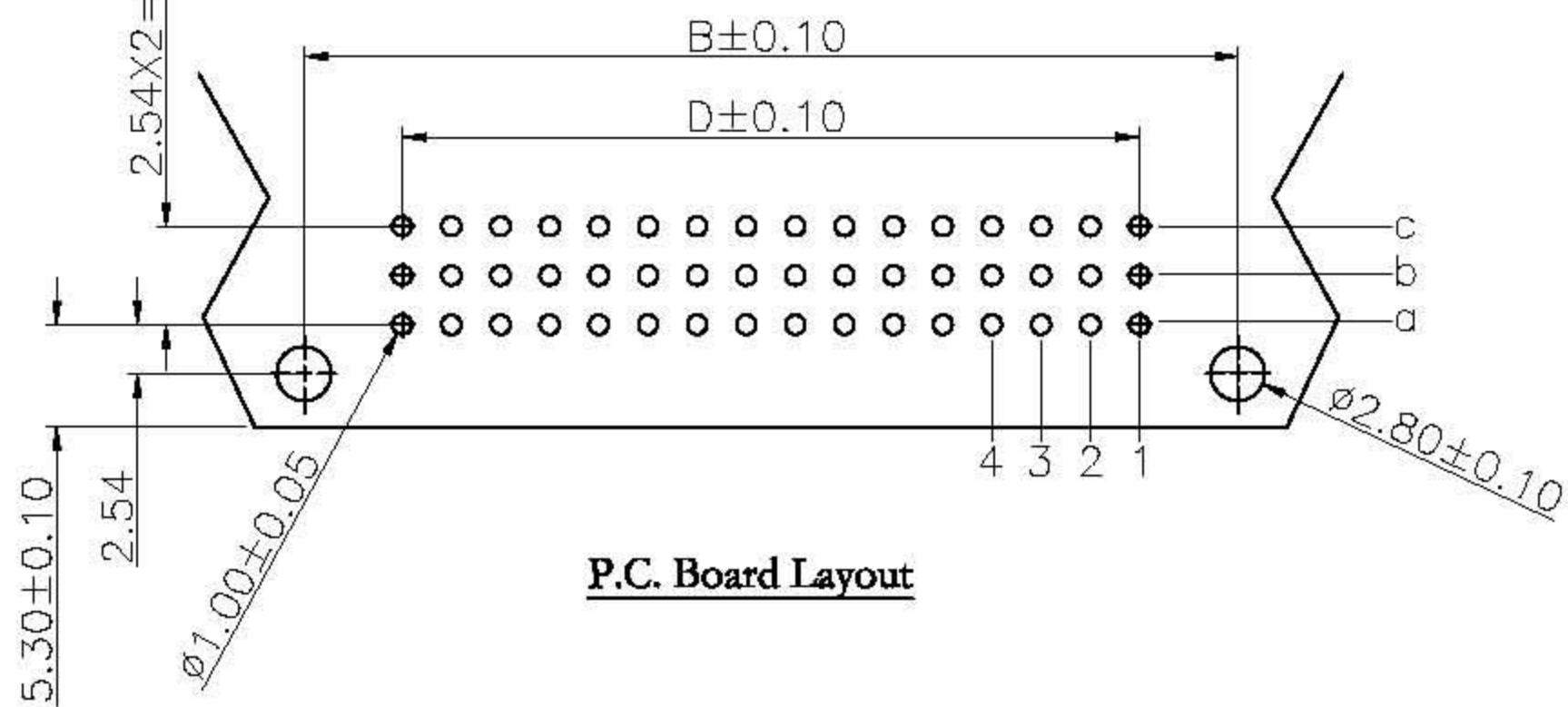
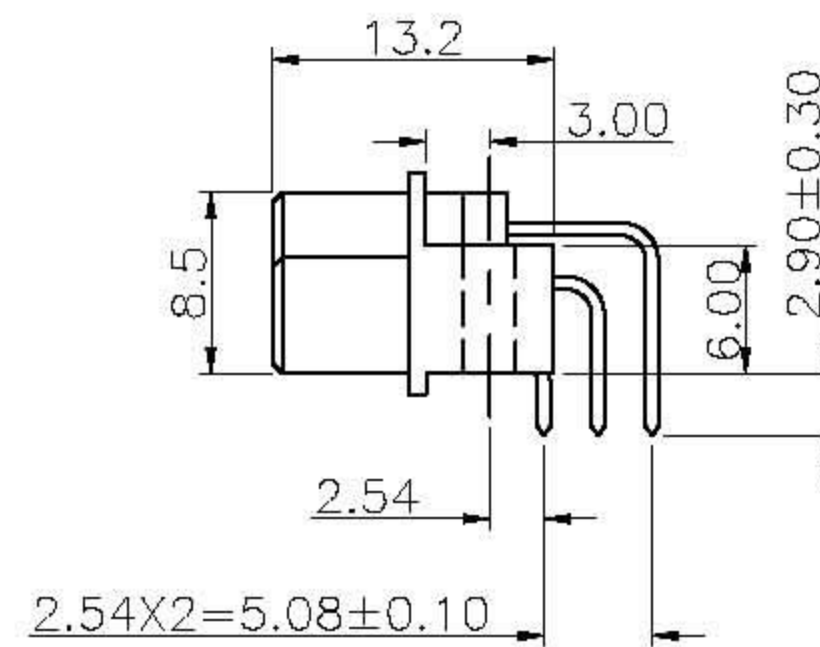
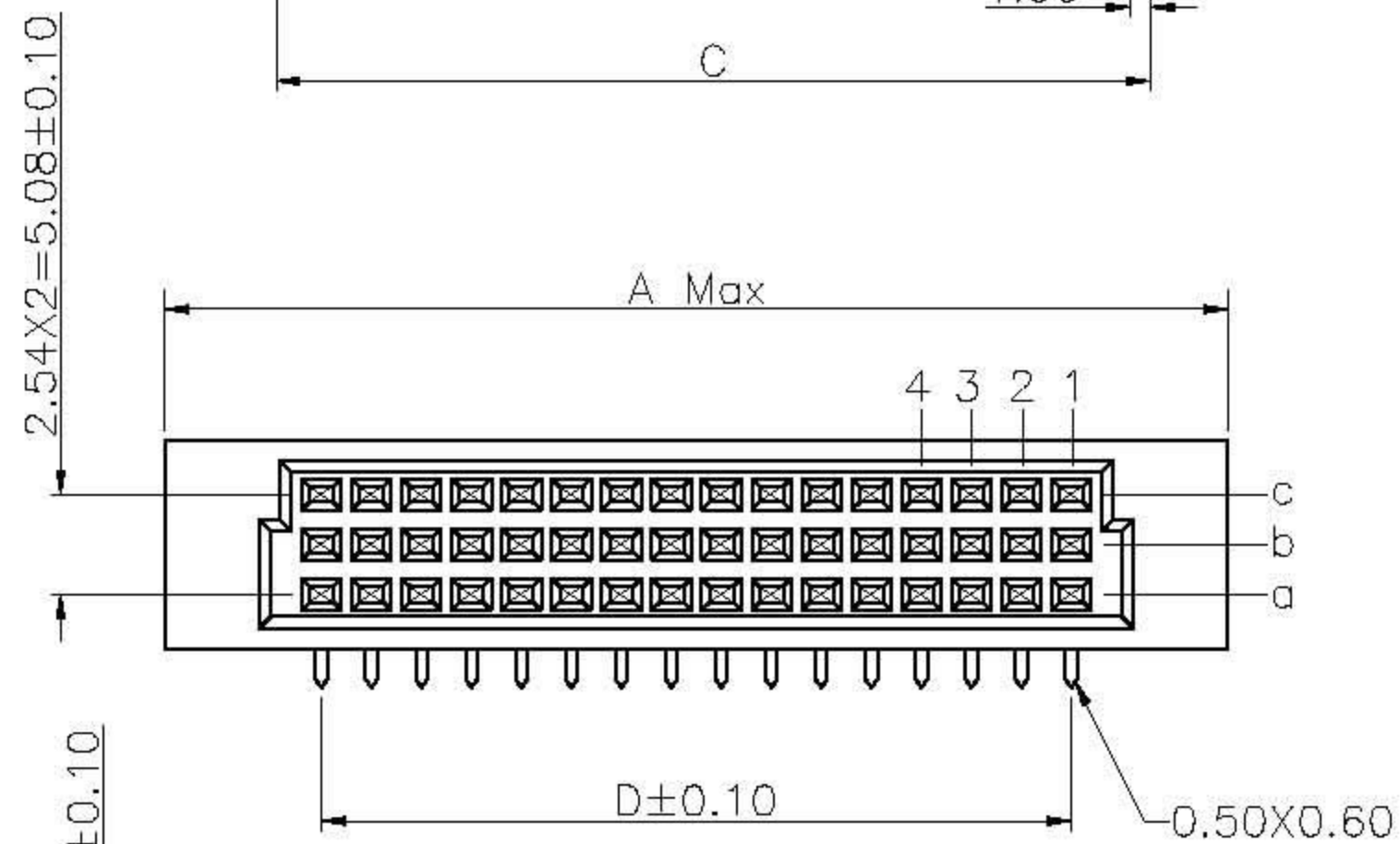

P.C. Board Layout

Tolerances	Drawn No.	Title:	
x = ± 0.5	Projection	\oplus	\triangleleft
.x = ± 0.25	Unit mm	Scale	1:1
.xx = ± 0.15	Drawn By	Liling 09/17'08	

DIN41612
Half R Type Female

上海国轩电子有限公司

P/N: DIN-348F200A

SHEET 1/1 Ver. No. R1