

Material:

Housing: PBT& Glass-filled, Rated UL94V-0.

Contacts: Phosphor Bronze, Gold Flash.

Plating: Selective gold plated on contact area nickel.

Shell: Cold Roller Steel.

Electrical Characteristics:

Current Rating: 1 AMP.

Dielectric Withstanding Voltage: AC 1000V For 1 minute.

Insulator Resistance: 1000M Ω min. at DC 500V.

Contact Resistance: 30m Ω max.

Operating Temperature: -55 $^{\circ}$ C~+105 $^{\circ}$ C.

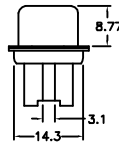
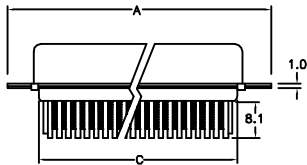
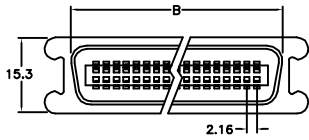

Position	A \pm 0.13	B \pm 0.1	C \pm 0.13
36	82.1	49.3	46.6
50	77.4	64.4	61.9

Ordering information

578- 10 500
 Series 10: Male 360: 36 Pin
 500: 50 Pin